

Notes

1. This drawing is to be read in conjunction with all the relevant contract documentation.
2. All dimensions are in mm unless otherwise stated. Dimensions to be checked on site prior to construction and any discrepancies reported to the Rolton Group Engineer.
3. Only drawings that indicate CONSTRUCTION as the issue purpose should be used for construction.
4. Any CONSTRUCTION status issue does not provide or imply approval or validation of any third party information.
5. Revision clouds are shown for assistance only, the whole drawing is to be checked for new/ amended information.
6. Not all hatches and linetypes shown on legends and keys may be present on this drawing. Drawings to be printed in colour by default, typical material colours are for clarity only.
7. Refer to drawing 200427-RGL-ZZ-ZZ-DR-S-240-0001 for foundation details and notes.
8. Minimum foundation widths to be (UNO):
 - 600mm - For external wall foundations.
 - 450mm - For internal wall foundations.
 - 600mm - For external wall foundations with anti-heave.

References

The foundation layout on this drawing has been designed in accordance with the following information:

Planning/Site layout	GSS Architecture drawing "Proposed Site Plan" (sk)13c Received January 2021.
Engineering layout	Rolton Group "Heelands Community Centre, Milton Keynes - Proposed Drainage and Levels Layout" 200427-RGL-ZZ-XX-DR-D-120-0001 Rev. S2-P01 dated March 2021.
Private Drainage	Rolton Group "Heelands Community Centre, Milton Keynes - Proposed Drainage and Levels Layout" 200427-RGL-ZZ-XX-DR-D-120-0001 Rev. S2-P01 dated March 2021.
Topographical survey	MK Surveys "Heelands Community Centre, Milton Keynes, Buckinghamshire - Topographical Survey" dated November 2020.
Foundations details	Rolton group drawing 200427-RGL-ZZ-ZZ-DR-S-240-0001
SI Report	Listers Geo Report "Ground Investigation, Langcliffe Drive, Heelands, Milton Keynes. Report No. 20.11.055 dated Dec 2020.
Retaining walls	Rolton Group "Heelands Community Centre, Milton Keynes - Proposed Drainage and Levels Layout" 200427-RGL-ZZ-XX-DR-D-120-0001 Rev. S2-P01 dated March 2021.

10. No allowance has been taken into account for the effects of proposed planting on foundation depths.
11. Foundations are shown for pricing purpose only and subject to change following receipt of construction issue drawings.
12. Layouts to be reviewed and verified by Bradwell Parish Council and Architect to ensure layout matches plot specific requirements.
13. It has been assumed that any drainage clashes will be resolved prior to excavations taking place on site, Civil Engineer to Review.

KEY

- BoF = +104.390 Denotes bottom of foundation level.
- Denotes extent of compressible material to inside face of foundation. Refer to foundation details for specifications.
- 250mm Step Denotes step to underside of foundation.

LEGEND

- Min 0.9m deep
- 1.25m deep
- 1.50m deep
- 1.75m deep
- 2.00m deep
- 2.25m deep
- 2.50m deep
- Consult engineer

NOTE

- Tree influence rings are based on a medium shrinkage soil in accordance with NHBC guidance.
- Where existing trees are to be retained, the tree influence line shown represents the influence of the tree at its mature height.
- When determining heave protection requirements existing tree heights have been used.
- When a tree is over half its mature height, mature height has been used.
- Currently no allowance for proposed planting has been allowed in the proposed foundation design.

Any penetrations through the floor/membrane to be set out to Architect's/Specialist's details

Exact location of bin/cycle store unknown, however adopt a 200mm thick concrete slab for bin/cycle store with 1 layer A252 mesh top and bottom laid on well compacted 150mm thick hardcore. Refer to the Architects site layout for exact location.

Refer to drawing ZZ-00-DR-S-710-0001 - Masonry Substructure Layout for Ground floor plans.

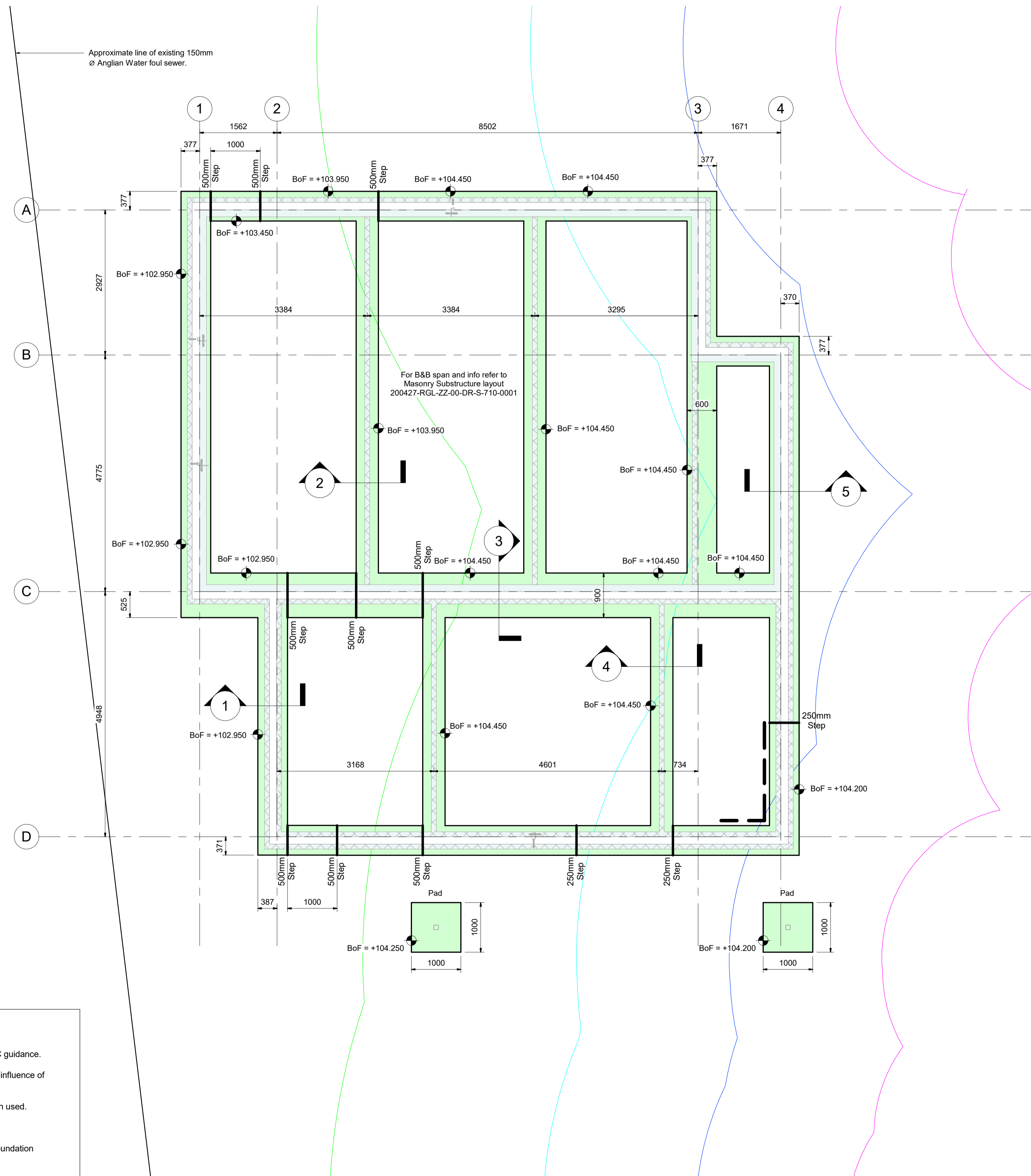

DO NOT SCALE Copyright Rolton Group Ltd 2021

This drawing shall remain the copyright of Rolton Group Ltd.

Standard construction hazards that a competent contractor would be aware of have not been identified on this drawing. Risks that may not be immediately apparent are listed below.

East Anglia Water deep drainage run

Status	Date	Description	Dim	Eng	Chkd	Ver
D2-P01	19.03.21	Issued for tender		JSM	GUS	AJB
D2-P02	15.08.22	Drawing updated to reflect latest Architect model		AJ	GUS	AJB



ROLTON GROUP
ENGINEERING THE FUTURE™
www.rolton.com 01933 410909

Project:
**Heelands Community Centre,
Milton Keynes - up to RIBA Stage 3**

Drawing title:
Foundation - General Arrangement

RGL Project Ref: 20-0427	Scale@A1 1 : 50	Scale@A3 1:100
Specification(s): N/A		

Drawing Number: 200427-RGL-ZZ-00-DR-S-210-0001	Status: D2-P02
Project Originator/Zone/Level/Type/Role/Classification/Number	Suitability/Revision
Issue Purpose: TENDER	