

Our Ref: 20215741 Your Ref: 20-0427

Wednesday, 14 October 2020

Tracey Mehew
The Charles Parker Building Midland Road
Higham Ferrers
Northamptonshire
NN10 8DN

Dear Tracey Mehew

Thank you for your enquiry dated Wednesday, 14 October 2020

Please find an extract from our mains records for your proposed work area, any SGN assets are described in the map legend. **On some occasions blank maps may be sent to you, this is due to your proposed work being in a no gas area but within our operational boundaries.**

This mains record only shows the pipes owned by SGN in our role as a Licensed Gas Transporter (GT). Please note that privately owned gas pipes or pipes owned by other GTs may be present in this area and information regarding those pipes needs to be requested from the owners. If we know of any other pipes in the area we will note them on the plans as a shaded area and/or a series of x's.

The information shown on this plan is given without obligation or warranty and the accuracy cannot be guaranteed. Service pipes, valves, siphons, stub connections etc. are not shown but their presence should be anticipated. Your attention is drawn to the information and disclaimer on these plans. The information included on the plan is only valid for 28 days.

On the mains record you may see the low/medium/intermediate pressure gas main near your site. There should be no mechanical excavations taking place above or within 0.5m of a low/medium pressure system or above or within 3.0m of an intermediate pressure system. You should, where required confirm the position using hand dug trial holes.

A colour copy of these plans and the gas safety advice booklet enclosed should be passed to the senior person on site in order to prevent damage to our plant and potential direct or consequential costs to your organisation.

Safe digging practices in accordance with HSE publication HSG47 "Avoiding Danger from Underground Services" must be used to verify and establish the actual position of the mains, pipes, services and other apparatus on site before any mechanical plant is used. It is your responsibility to ensure that this information is provided to all relevant people (direct labour or contractors) working for you on or near gas pipes.

It must be stressed that both direct and consequential damage to gas plant can be dangerous for your employees and the general public and repairs to any such damage will incur a charge to you or the organisation carrying out work on your behalf. Your works should be carried out in such a manner that we are able to gain access to our apparatus throughout the duration of your operations.

If you require any further information please do not hesitate to contact us.

Yours sincerely,
The Safety Admin Team
For more information, visit our Dig Safely pages on sgn.co.uk
Tel: 0800 912 1722

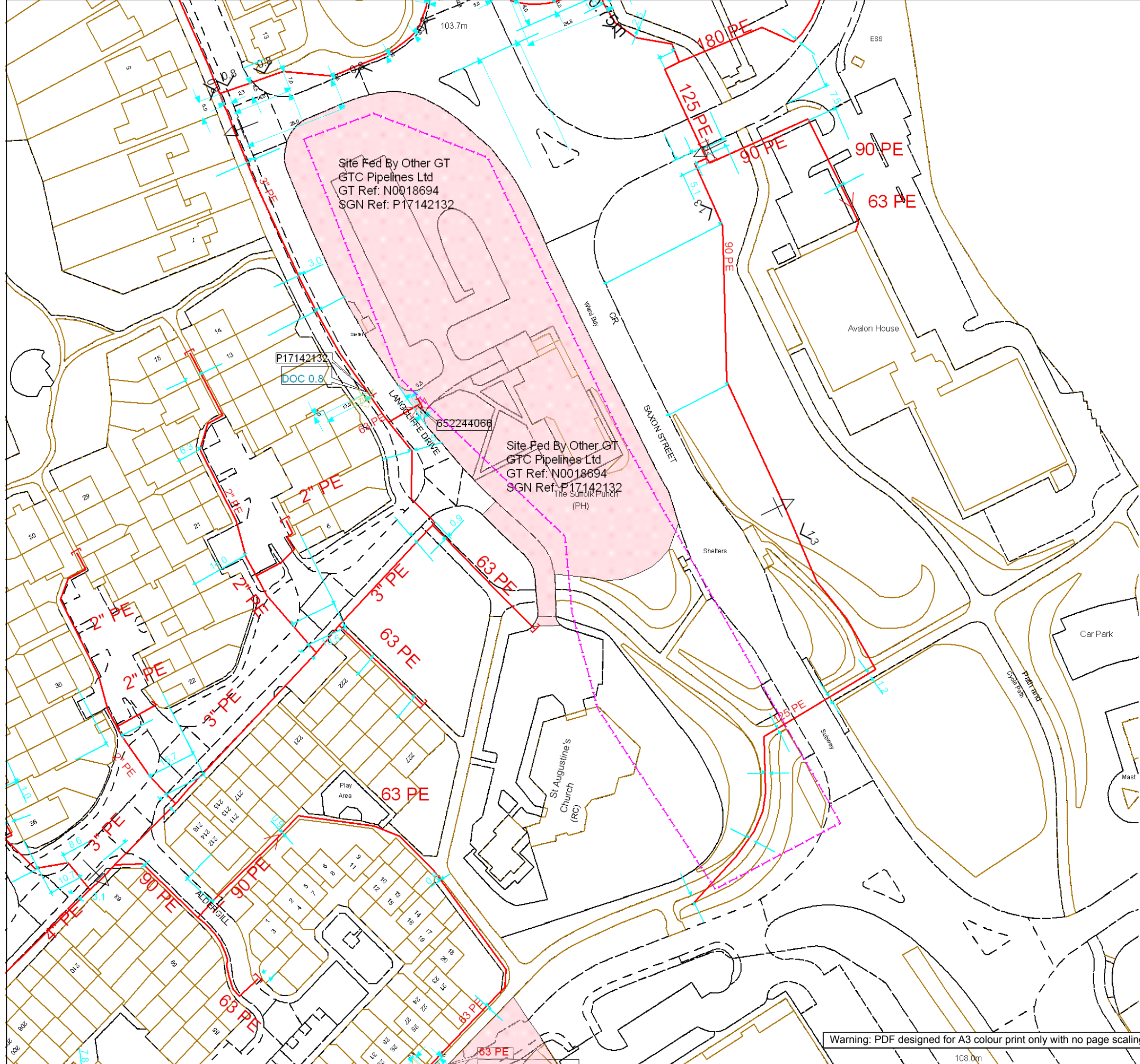

Contact Us
Mapping Enquiries:
All areas

General Enquiries:
All areas

Date Requested: 14/10/2020
Job Reference: 20215741
Site Location: 484345 240242
Requested by:
Miss Tracey Mehew
Your Scheme/Reference:
20-0427
Exact Scales:
1:1000 Area or Circle dig site
1:1000 Line dig site

This plan shows the location of those pipes owned by Scotia Gas Networks (SGN) by virtue of being a licensed Gas Transporter (GT). Gas pipes owned by other GTs or third parties may also be present in this area but are not shown on this plan. Information with regard to such pipes should be obtained from the relevant owners. No warranties are given with regard to the accuracy of the information shown on this plan. Service pipes, valves, siphons, sub-connections etc. are not shown but their presence should be anticipated. You should be aware that a small percentage of our pipes/assets may be undergoing review and will temporarily be highlighted in yellow. If your proposed works are close to one of these pipes, you should contact the SGN Safety Admin Team on 0800 912 1722 for advice. No liability of any kind whatsoever is accepted by SGN or its agents, servants or sub-contractors for any error or omission contained herein. Safe digging practices, in accordance with HS (G)47, must be used to verify and establish the actual position of mains, pipes, services and other apparatus on site before any mechanical plant is used. It is your responsibility to ensure that plant location information is provided to all persons (whether direct labour or sub-contractors) working for you on or near gas apparatus. Information included on this plan should not be referred to beyond a period of 28 days from the date of issue.

Report damage immediately – KEEP EVERYONE AWAY FROM THE AREA
0800 111 999

Low Pressure Mains

Medium Pressure Mains

Intermediate Pressure Mains

High Pressure Mains

LAs

GTs

Some Examples Of Plant Items

Valve

Syphon

Depth of Cover

Diameter Change

Material Change

Digsite: Line:

Area:



This plan is reproduced from or based on the OS map by Scotia Gas Networks plc, with the sanction of the controller of HM Stationery Office. Crown Copyright Reserved. Southern Gas – 100044373 and Scotland Gas – 100044366.

Map Symbols

VALVE OPEN	VALVE CLOSED	GOVERNOR	END CLOSURE	SYPHON	REDUCER	TEE
TEST POINT	CATHODIC PROTECTION	GENERAL REFERENCE	FLOW MEASURE	DIP POINT	MONO ETHYLENE GLYCOL	OILING POINT
FLOW STOP	PRESSURE MEASUREMENT	STAND PIPE	OFFICIAL MINISTRY RECORD	PURGE POINT	GAS CONDITIONER	DRAIN POINT
					LP MAINS	
SKETCH BUBBLE	DEPTH OF COVER	METER	MATERIAL CHANGE		MP MAINS	
					IP MAINS	
					LHP MAINS	
					HISTORY DATA	
					SSSI	
PIG TRAP	CROSSOVER CONNECTION	CHANGE OF DIAMETER	PIPE JOINT		CONTACT ZONE	
						LTS

Safety Advice - Valves



Guidance when undertaking work near gas valves in our network areas

SGN manages the network that distributes gas to 5.8 million homes and businesses across Scotland and the south of England.

Due to a manufacturing issue, we are currently replacing or upgrading certain valve types that are at risk of bolt failure. In extreme cases, this can lead to gas escapes. This is a safety hazard and we have produced this guide to ensure you undertake adequate safety precautions when working near gas valves.

Identifying gas valves

The images below are an illustration of typical gas valves. Please note, valves come in various colours, shapes and sizes, and you may come across a valve that looks different to those found in the images.

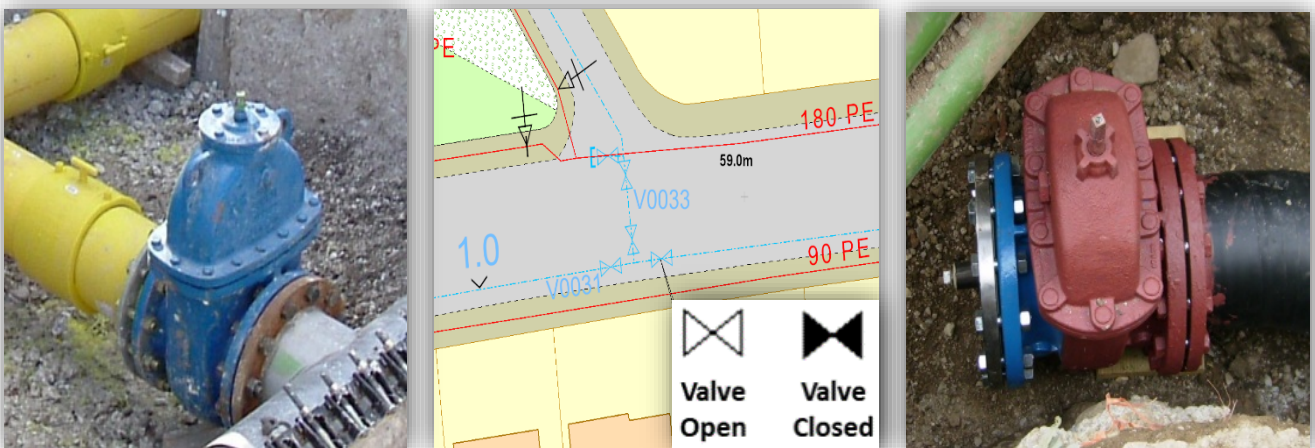

What should you do?

When planning to work in our network areas, please observe the following points:

1. You must contact us before starting any work activity within **3.0m** of a gas valve identified on our maps.
2. If an unexpected gas valve is exposed you must immediately stop excavation works and report this to us.
3. To protect yourself against the risks associated with exposing a valve, we advise that you contact us when in doubt.

Contact details

If you require further information or need assistance please contact us:

Safety Admin Team: **0800 912 1722**
plantlocation@sgn.co.uk

Valve enquiries will be forwarded to a local engineer who will provide further safety information.



SGN

Your gas. Our network.

Dig safely

Measures to avoid injury
and damage to gas pipes



The following protective and precautionary measures MUST be taken when working in the vicinity of gas mains and services.

It is the responsibility of the property owner or company carrying out the work to make sure they've complied with the relevant legislation and Health and Safety Executive (HSE) guidance, eg HS(G)47. In practice, this means that whoever is carrying out the work MUST obtain gas mains location information and/or maps showing the indicative position of the gas network before any work takes place.

To avoid injury to yourself, your employees, colleagues and the general public you MUST suitably mark the position of the pipes on site.

HS(G)47 outlines best practice that should be followed to ensure you work safely:

1. Plan the work, obtain maps.
2. Detecting, identifying and marking underground services.
3. Safe excavation and safe digging practices.

In addition to the requirements under the Health and Safety At Work etc. Act 1974 to prevent injuries to employees and others (not employed), it is an offence under regulation 15 of the Pipelines Safety Regulations 1996 to cause damage to a pipeline (which includes gas mains and services as well as higher pressure pipelines) so as to give rise to a danger to persons.

You MUST make sure that current full colour copies of our maps are issued to all relevant personnel on site and they're aware of the presence and location of our gas mains and services prior to any excavation.

In a gas emergency

If you cause a gas leak or suspect a main or service pipe or equipment is leaking, you **MUST** take the following emergency actions immediately:

- **Ask people to move away from the area of the gas escape.**
- **Call 0800 111 999 immediately.**

1. **Don't attempt to repair the escape or stop the leakage.**
2. **As gas may enter buildings, ask people in the surrounding premises to leave until it's safe for them to return.**
3. **Stop anyone going near the immediate vicinity of the gas escape.**
4. **Prohibit smoking and extinguish all naked flames.**
5. **Don't use mobile phones or other ignition sources.**
6. **Assist our representatives and other emergency services such as the police, ambulance, and fire service as requested.**

Additional reference material

- SGN guidance for Safe Working in the Vicinity of Pipelines & Associated Installations operating >7barg. Applicable for HP only.
- HS(G)47 **Avoiding Danger from Underground Services** available from hse.gov.uk
- NJUG **Utilities Guidance on Positioning and Colour Coding of Apparatus** available from njug.org.uk





Making an enquiry for gas mains or services maps

Please visit our **Dig safely** pages on **[sgn.co.uk](https://www.sgn.co.uk)** for plant protection information and links to our online mapping system and other associated information and guidance.

Our simple and easy to use online mapping system is available 24/7, 365 days a year.

You'll need to register/log in and provide a few details about your site location and the work you'll be carrying out. We'll respond immediately by email.

What you're likely to be sent

You'll be sent an email with a map. This will be an extract from our gas mains record, showing your site and any of our gas pipes as well as relevant safety information.

We always send out safety information, however we may forward your enquiry on to a local plant protection officer or a pipelines engineer to make direct contact with you depending on the work location.

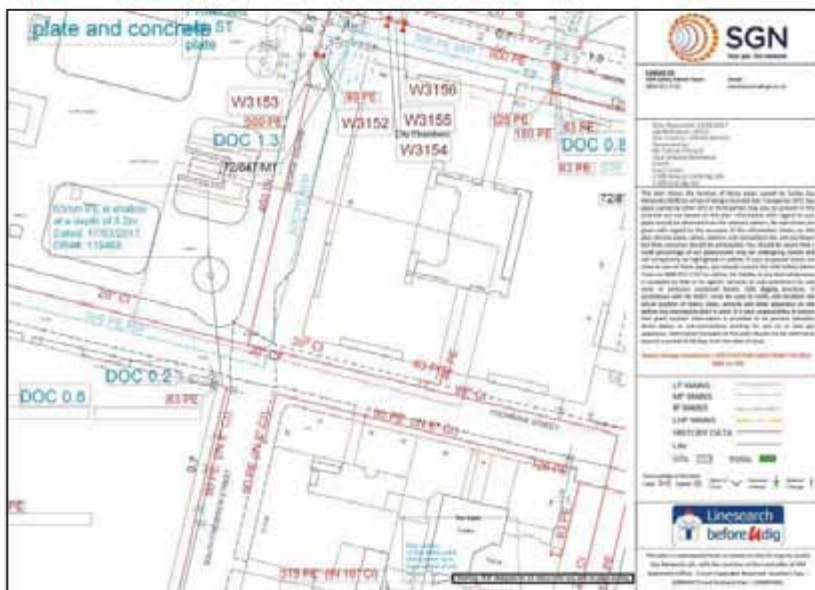

Example of a gas map

Note: Service pipes are not shown on our maps

When working near our gas mains and services

Safe system of work

To satisfy ourselves that work in the vicinity of our gas mains is being carried out safely, we may ask for a copy of your risk assessment and/or method statement paperwork.

Where work falls under the Construction (Design and Management) Regulations 2015 reference to our gas mains and services **MUST** be made within your site Health and Safety file.

Financial

Every reasonable precaution **MUST** be taken to avoid personal injury or damage to our gas network at all times.

If we incur any costs to repair direct or consequential damage or divert any gas main or service, you'll be recharged in full.

HSE

Any damage to our gas mains or services will be subject to legislative reporting responsibilities to the Health and Safety Executive under Reporting of Injuries, Diseases & Dangerous Occurrences Regulations 2013, Gas Safety Management Regulations 1996, and the Pipelines Safety Regulations 1996.

Minimum safe working distances

Depending on the activity being undertaken and the gas mains or services you are working within the vicinity of, there are different safe distances that **MUST** be adhered to. SGN plant protection officers or pipeline engineers will inform you of these if required.

Surface boxes and manholes

Do not bury or move our surface boxes. Free access **MUST** be maintained during and after your work. No manhole cover or other structure can be built over, around or under a gas main, and no work is to be carried out that results in a reduction or increase in cover or protection without prior written agreement.

Deep excavations

Adequate protection, approved by us, **MUST** be applied for any deep excavations in the vicinity of our gas mains and services that may affect its security and integrity. Ground movement around gas mains **MUST** be prevented. We **MUST** be contacted if a sewer trench or any other water authority is to be constructed at greater than 1.5 metres depth near a buried gas main or service pipe. You **MUST** give us detailed drawings showing the line and width of the proposed sewer or other trench, together with the soil group classification of the area concerned.



Crossing our mains or services

The placing of heavy construction plant, equipment, materials or the passage of heavy vehicles over our gas mains is prohibited unless specifically agreed protective measures (ie the construction of reinforced crossing points) have been carried out. This is particularly important where reductions in side support or ground cover are planned. You **MUST NOT** carry out any work in servitudes/easements without our prior written consent.

Exposed plant

Where excavations in the vicinity of our gas mains affect its support, the plant **MUST** be adequately supported and protected in consultation with us and to our satisfaction. It **MUST** be protected from impact, restraints and thrust blocks, and supports **MUST NOT** be removed without our agreement.

Hot work

One of our representatives should be present when welding or other hot work involving naked flames is being carried out near our gas mains, as there's potential for heat damage to plastic pipeline/coatings.

Backfilling

Concrete backfill should not be placed closer than 300mm to our mains. No concrete or hard material should be placed under or adjacent to any of our gas mains. Shuttering **MUST** be constructed to maintain the stated clearances and prevent fresh concrete encasing our mains or services. Material used for backfill around our gas mains **MUST** conform to the following:

- If sand, it **MUST** be well-graded in accordance with BS EN 12620:2002.
- It **MUST NOT** contain any sharp particles (stones, bricks, lumps or corrosive materials).
- Foamed concrete **MUST NOT** be used.
- It **MUST** be laid to a minimum depth of 250mm above the crown of the gas main.

Note: Power ramming **MUST NOT** take place until a 300mm hand rammed layer has been completed over the crown of the main.

Access





Free access to our sites, mains and services, including temporary structures and spoil heaps **MUST** be available at all times.





Mechanical excavation

Mechanical excavators (including breaker attachments) **MUST NOT** be used within the following distances from the confirmed location of our gas mains and services shown on our gas maps without prior agreement:

Type of mains and services	Gas map identification	Hand excavation required inside	Pipe pressure indication shown on map
Low Pressure (LP)	0 - 75mbar	0.5 metres	
Medium Pressure (MP)	75mbar to 2 bar	0.5 metres	
Intermediate Pressure (IP)	2 - 7 bar	3.0 metres	
High Pressure (HP)	Above 7 bar	You must seek approval from us prior to any work	

Major accident hazard pipelines

High pressure pipeline

No work is to take place near an HP pipeline until it is agreed with us. After agreement and before any work does take place, the location of our pipeline **MUST** be marked up and its position confirmed by digging trial holes with our personnel in attendance.



Pipeline markers

High pressure

We will be involved in any work taking place near high pressure pipelines. We will provide you with additional information that you **MUST** familiarise yourself with before carrying out any work.

The default method of excavating near high pressure gas pipelines MUST always be by hand.



Wind turbines

The UK Onshore Pipelines Operations Association (UKOPA) has identified the appropriate exclusion zone (distance from the base of the wind turbine mast to the edge of the pipeline) as 1.5 times the turbine height. Contact MUST be made with us during the planning stages of a wind turbine or wind farm.



Tree planting

If trees or shrubs are to be planted in the vicinity of our gas mains and services, the selection of tree or shrub type and how it's planted **MUST** be considered carefully. This is to avoid root damage to buried mains or services, and to ensure our subsequent excavations for main repair and maintenance won't damage the trees or shrubs.

Written approval from us **MUST** be obtained before any tree planting is carried out on a servitude/easement. Any approval we grant to plant trees

The following trees and those of similar size (deciduous or evergreen) **MUST NOT** be planted within 6m of the centre line of the main: ash, beech, birch, most conifers, elm, maple, lime, horse chestnut, oak, and sycamore. Apple and pear trees are also included in this category.

Dwarf apple stocks may be planted up to 3m of the centre line of the main.



In cases where screening is required, the following are shallow rooting and may be planted close to the gas mains and services: blackthorn, broom, cotoneaster, elder, hazel, laurel, quickthorn, privet, snowberry and most ornamental shrubs.

Gas main centre

Raspberries, gooseberries and blackcurrants may be planted on the gas main, but a four metre strip, centred on the main, **MUST** be left clear at all times.

on a servitude/easement will be subject to us retaining the right to remove any tree, which in our opinion may become a danger to our mains in the future.

The written consent to plant trees will state what area may be planted and also the type of tree. The diagram details the specific species and the distances they **MUST** be planted from gas mains or services. You **MUST** contact us for further information.

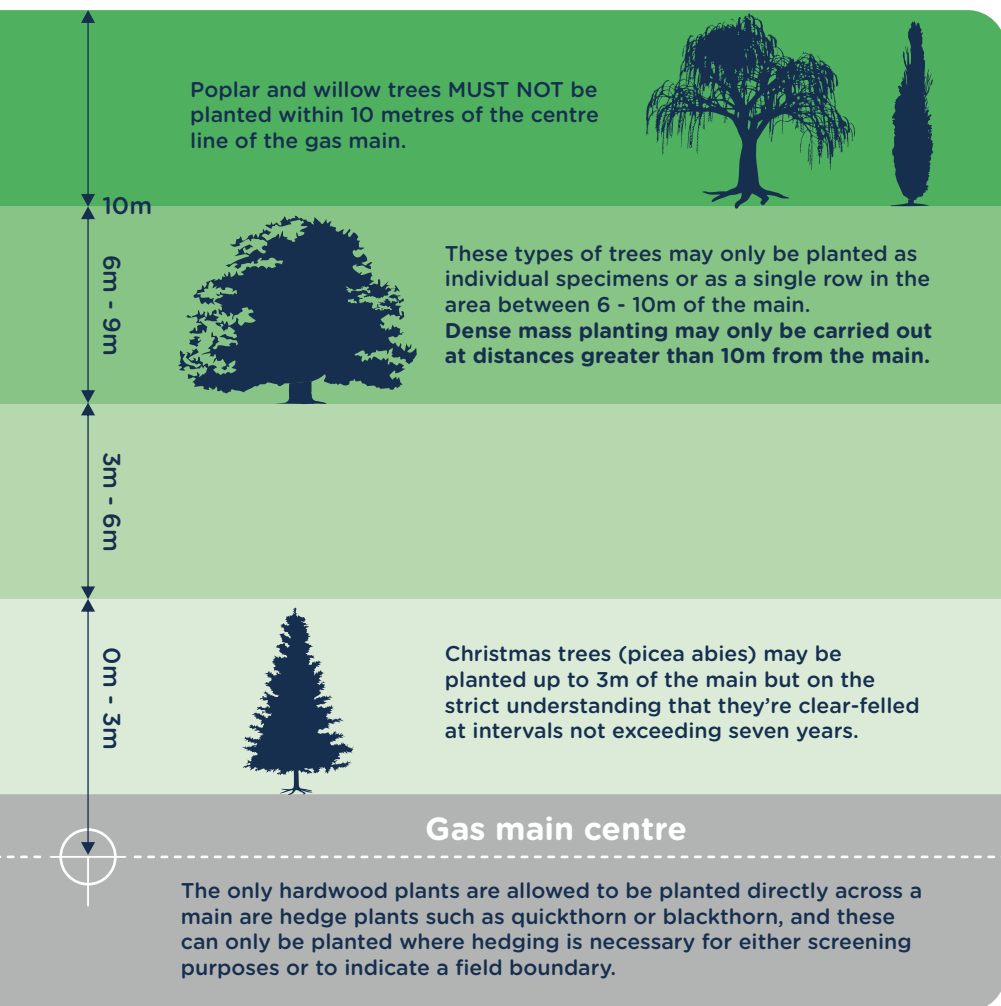

Note: For further guidance, please refer to NJUG 10.

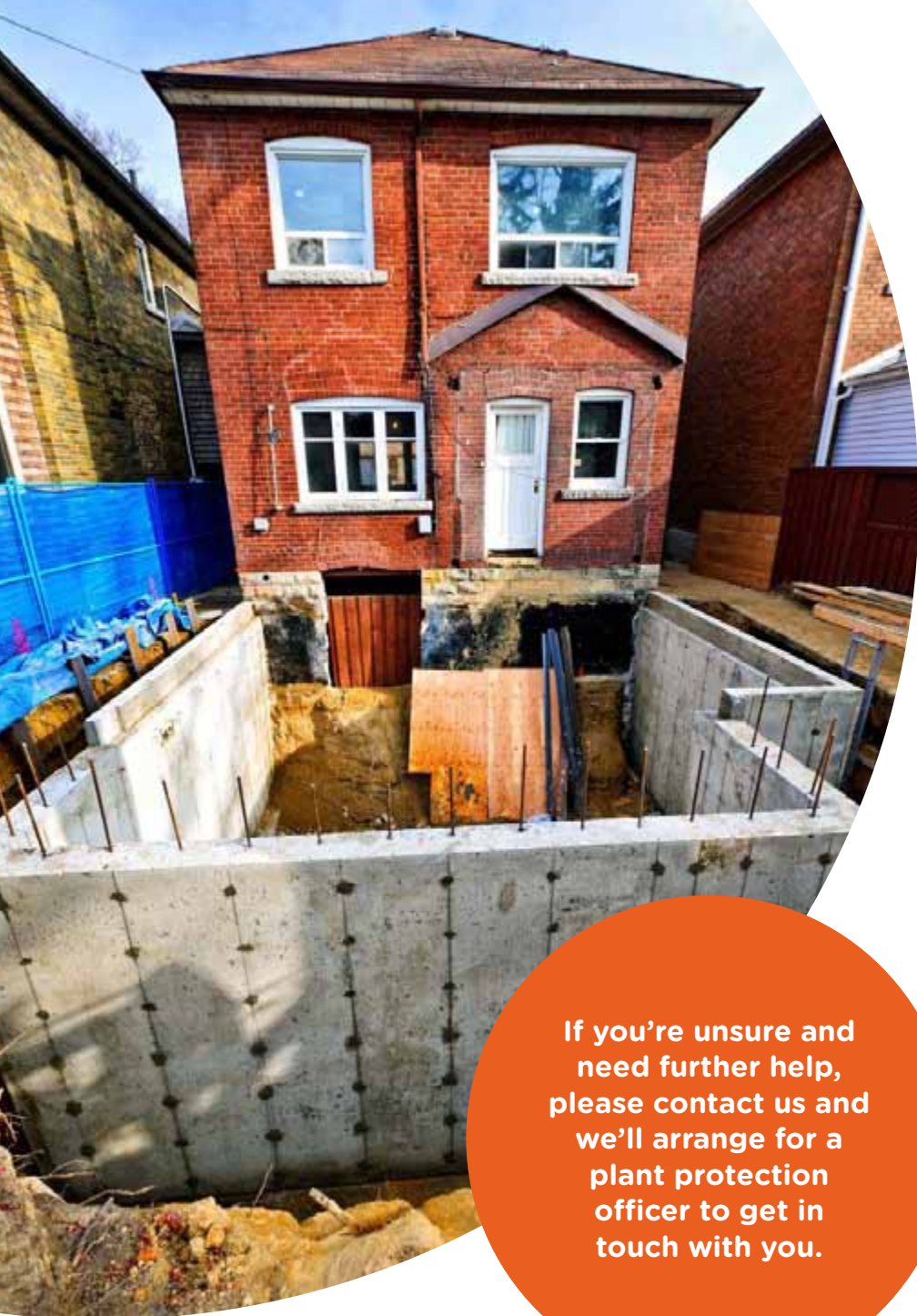

If you're unsure and need further help, please contact us and we'll arrange for a plant protection officer to get in touch with you.

Gas services/work in gardens

If you're going to be carrying out work around your home, or a third party is carrying out work on your behalf, we may send you a site map of our gas mains and services but your own gas service won't be marked.

The simplest way to understand the location of your gas service is to know where it enters your house.



< Your gas service pipe usually takes the shortest route to the gas main, as shown on the sample network map/drawing.



We provide a free plant location enquiry service and we're always happy to help.



Visit our **Dig safely** pages on **sgn.co.uk**



0800 912 1722 *

*All calls are recorded and may be monitored