

Do not scale from this drawing for construction or acquisition purposes. Responsibility is not accepted for errors made by others in scaling from this drawing. All construction information must be taken from figured dimensions only. All dimensions and levels must be checked on site and discrepancies between drawings and specification must be reported to GSSArchitecture.
© Copyright GSSArchitecture

Ordnance Survey © Crown Copyright 2018. All rights reserved. Licence number GSS 100017356.

Map Data Copyright 2018 Google.

- Key:**
- Site Boundary
 - Medium/ Tall Shrubs
 - Existing Trees
 - RPA's
 - Proposed Tree
 - Ground Cover Shrubs
 - Paving/ Tarmac
 - Concrete Slab Finish (External Plant and Bin Store)
 - Paving Slabs
 - Existing Hedgehog Pass
 - Sparrow Terrace fixed to wall
 - 1.8M high closeboard fence and lockable gate
 - Sewer Pipe
 - Minimum building distance from sewer pipe
 - Retaining Wall extent as per Civil Engineers drawing

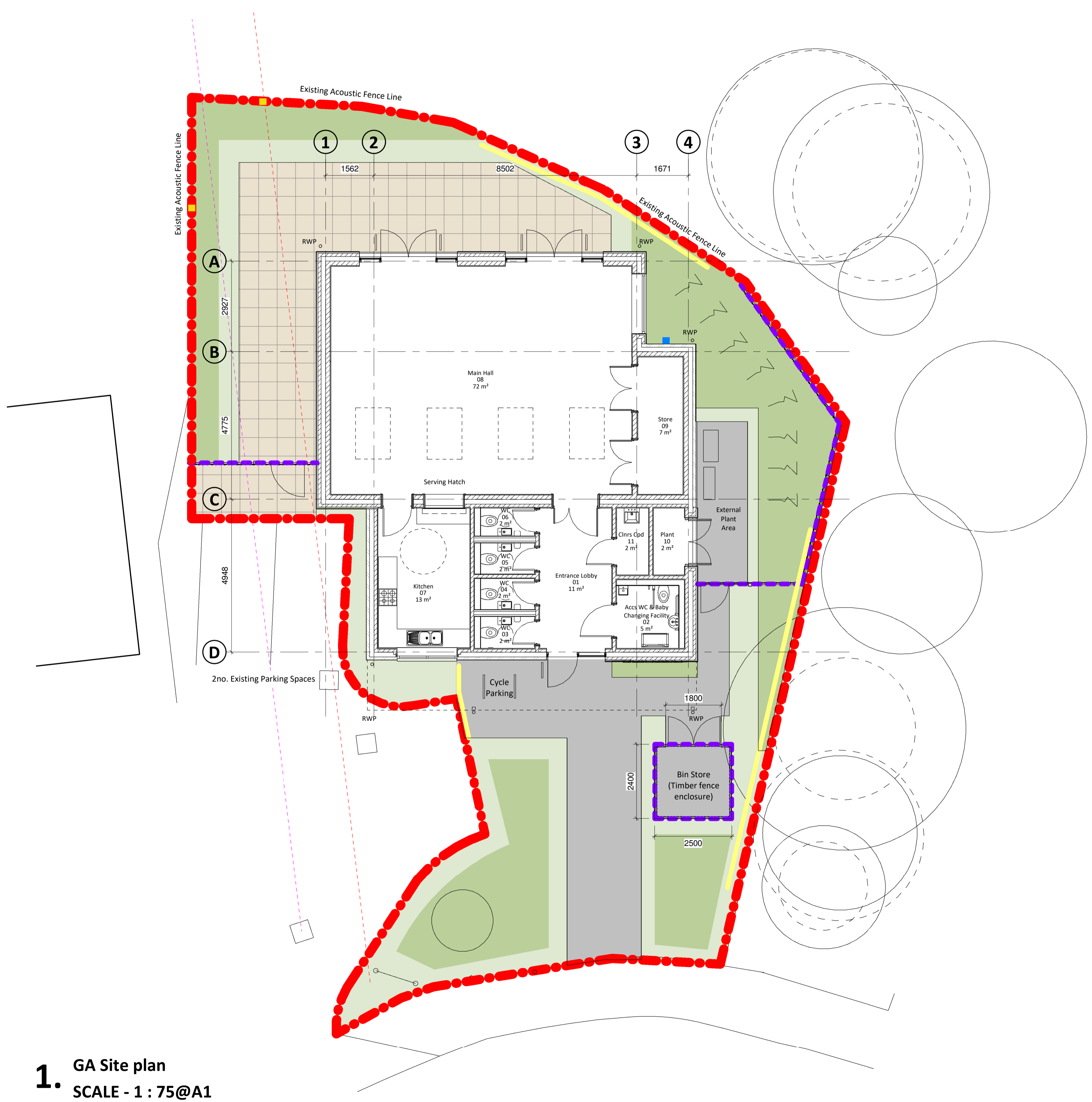

1. GA Site plan
SCALE - 1 : 75@A1

Rev.	Date	Drawn	Check	Description
B	31/08/22	JAM	CC	GA Site Plan updated to suit revised layout. Draft tender issue.
A	04/05/22	JXU	CC	Floorplan amended. First floor, Stairs and lift omitted.

Rev.	Date	Drawn	Check	Description
------	------	-------	-------	-------------

gssarchitecture
STUDIO B/2, 314 WITAN GATE WEST
CENTRAL MILTON KEYNES, MK9 1EJ
Telephone: 01908 010 030. Email: gss@gotch.co.uk,
Web: www.gssarchitecture.com
Gloucester: 01452 525 019, Kettering: 01536 513 165,
Harrogate: 01423 815 121, Newcastle: 01913 898 917

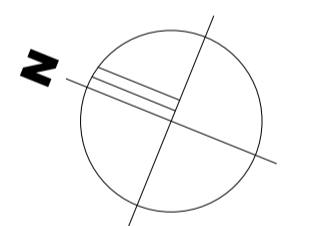

TENDER ISSUE

Project Title:
Community Centre, Heelands, Milton Keynes

Client:
Bradwell Parish Council

Drawing Title:
GA Site Plan

File Number:	Project No. H105
Drawn By:	SK
Checked By:	CC
Scale@A1:	1 : 75 Date: 04/05/22
Dwg No:	(00)10 Rev: B